

▶ ANTENNAS — TERRESTRIAL RECEPTION

FLASHD — Triple-Boom UHF TV Antenna

- Supplied completely assembled. Ultra-rapid installation. The antenna is unfolded by simply pressing a button.
- Convergent triple-boom, with 23 directors. W-Dipole. Dihedral reflector. All elements made of aluminium.
- Configuration of the dihedral angle: 90° or 120°. Two 'vertical plane' radiation patterns available.
- Clamping system for masts of $\varnothing 25$ to 50 mm. Variable clamp tilt: $\pm 40^\circ$. Horizontal or vertical polarization.
- Cable connection: F type. 1 screw-on plug and 1 rubber protection cap are supplied.
- ABS plastic connecting-box, with weatherproofing IP55 grade. The box is easily detachable for an easier coaxial cable connection.
- Impedance: 75 Ω

Triple-Boom UHF TV Antenna

FLASHD
Ref. 1782

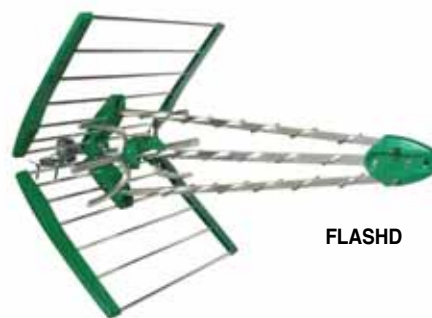

FLASHD

- Channels : **21 to 69** (470-862 MHz)
- Type : **Triple-Boom YAGI, 1 Dihedral Reflector**
- Gain : See graph below
- Front-to-Back ratio : **≥ 20 dB**
- Windload : **105 N** (130 km/h) , **150 N** (150 km/h)
- Connection : **F type**
- Length : **105 cm**
- Quantity boxed : **1**
- Packed weight : **3 kg**

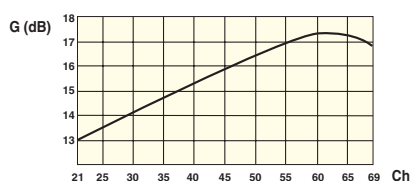

	470 MHz	670 MHz	860 MHz
Beamwidth			
90° DIHEDRAL Mode	55° (H) 65° (V)	40° (H) 50° (V)	25° (H) 30° (V)
120° DIHEDRAL Mode	55° (H) 55° (V)	40° (H) 40° (V)	25° (H) 23° (V)

■ ANTENNA UNFOLDING : TO PRESS A BUTTON

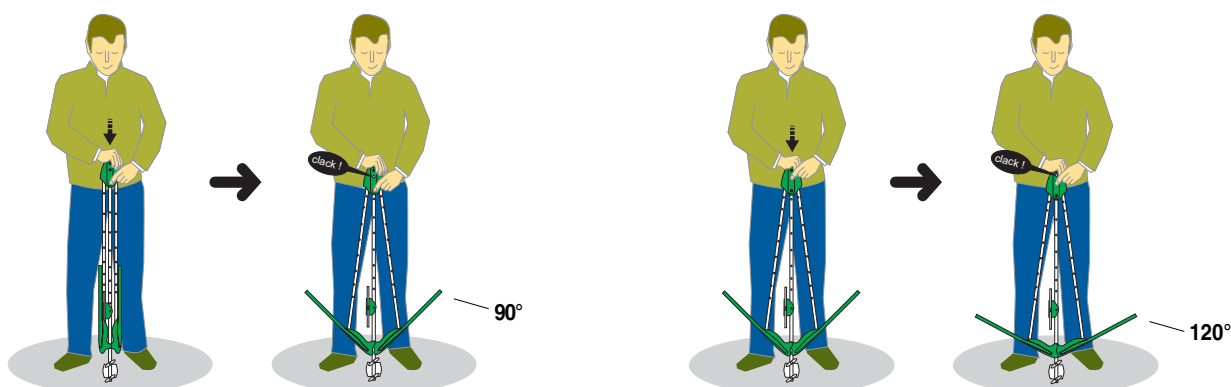

¿ 90° or 120° ?

- The 90° DIHEDRAL mode provides the best general performance of the antenna. The 120° DIHEDRAL mode can be tried out when existing echoes that with the 90° mode produce visible interferences.